

Gtech

Cordless Lawn Mower **CLM Series**

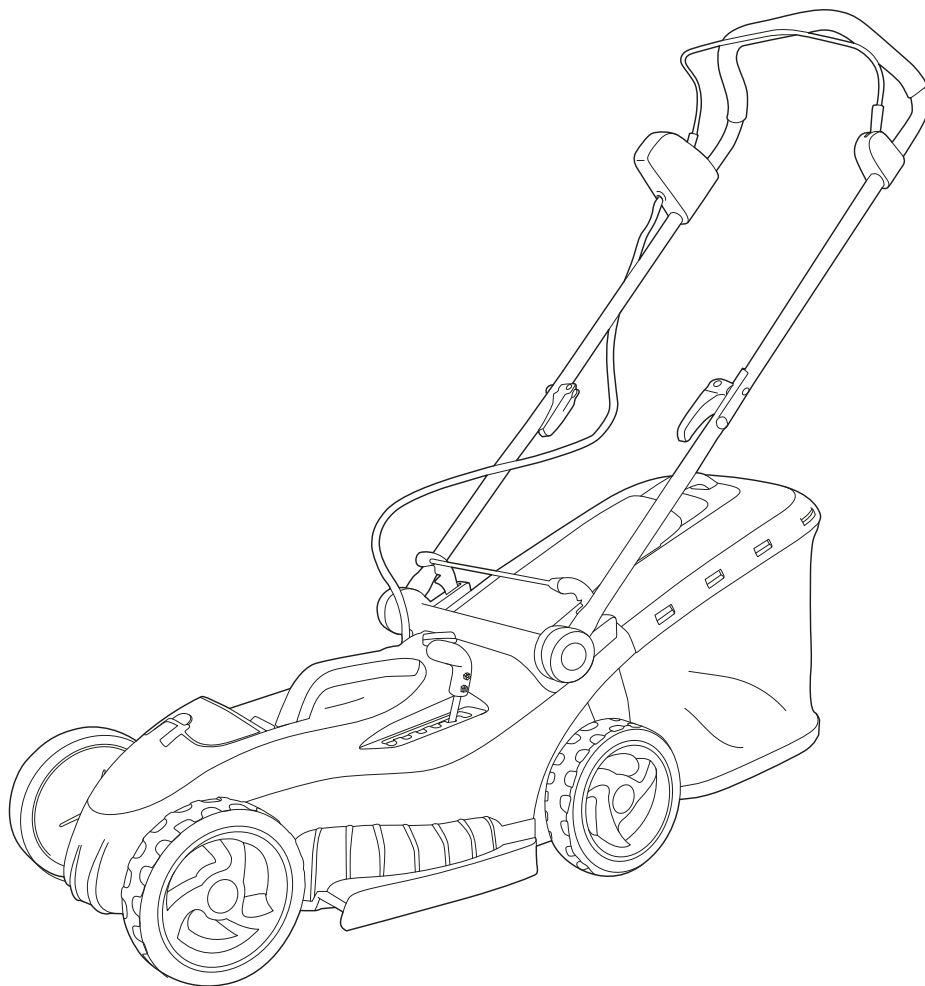

OPERATING MANUAL Original Instructions

IMPORTANT SAFEGUARDS:



IMPORTANT: READ ALL INSTRUCTIONS BEFORE USE. RETAIN INSTRUCTIONS FOR FUTURE REFERENCE.



Do not use in rain or leave outdoors whilst raining.



WARNING: Basic safety precautions should always be observed when using an electrical appliance to reduce the risk of fire, electrical shock or serious injury.

Personal Safety:

- Only use the mower on grass and lawns, as described in this manual.
- Keep out of reach of children and animals at all times.
- Only use in daylight or good artificial light.
- Do not use while there are other people, especially children, nearby.
- Stay alert, watch what you are doing and use common sense when operating the mower.
- Do not use the mower while you are tired or under the influence of drugs, alcohol or medication. This may result in serious personal injury.
- Always be aware of your surroundings and stay alert for possible hazards.
- Use protective personal equipment such as safety glasses, non-skid safety shoes, sturdy gloves to reduce the risk of personal injury.
- Do not operate when barefoot or wearing open toed shoes.
- Dress appropriately. Do not wear loose clothing or jewellery and keep hair, clothing and gloves away from moving parts.
- Mow across slopes, not up and down, taking care when changing direction.
- Always be sure of your footing on slopes or in slippery conditions.
- Do not use on excessively steep slopes.
- Take particular care when reversing with the mower or pulling it towards you.
- Never touch the rotating blade.
- Do not stand in front of the protective flap when opened.
- Do not open the protective flap while the motor is running.
- Never operate the mower over gravel, as this risks flicking stones.
- Check the area where the mower is to be used and remove any objects that could jam or be thrown by the mower, such as stones and sticks.
- Avoid operating the mower on wet grass.
- Check the grass box regularly for any wear and deformation.
- Do not use the mower without the grass box or other protective guards in place.
- Never operate the mower with damaged guards or without the guards in place.
- Visually check the cutting tools and their fasteners for any damage before each use.
- To prevent imbalance, any damaged or worn-out parts should be replaced.
- When operating the mower ensure that both hands are correctly positioned on the handle.
- Only start the mower when your feet are a safe distance from the cutting blade.
- Do not tilt the mower when starting the motor.

- Do not operate the mower if it is incomplete or has unauthorised modifications.
- Keep all body parts, especially hands and feet, away from the blade at all times.
- Warning, the blade will continue to move after the motor is switched off.
- Ensure that the blade has fully stopped and safety key has been removed before:
 - leaving the mower
 - clearing a blockage
 - adjusting the cutting height
 - emptying the grass box
 - lifting or carrying the mower
 - tilting the mower to move
 - checking or cleaning the mower
 - carrying out any maintenance
- If the mower vibrates intensively, stop the motor fully and identify the cause.
- The operator is responsible for accidents or hazards occurring to other people at their property.
- This appliance is not intended for use by persons (including children) with reduced physical, sensory or mental capabilities or lack of experience or knowledge.
- Never modify the mower in any way.

Electrical safety:

- Do not operate the mower in explosive atmospheres, such as in the presence of flammable liquids, gases or dust. Mowers create sparks, which may ignite the dust and fumes.
- Do not use the mower when a thunderstorm is approaching.
- Avoid body contact with earthed or grounded surfaces, such as pipes. There is an increased risk of electric shock if your body is earthed or grounded.
- Do not expose the mower to rain or wet conditions.

- Do not handle the charger or the mower with wet hands.
- Before charging check the power supply and charger cables for signs of damage or ageing.
- Do not expose the mower to temperatures exceeding 80°C, or leave the mower in direct sunlight or in the hot boot of a car for prolonged periods.

Battery safety:

- Do not attempt to use the charger with any other product or to charge this product with any other charger.
- Do not use the charger in moist or wet conditions or outdoors.
- Disconnect the cable connectors by pulling the plug only, never the charger.
- Do not use a damaged charger.
- Never cover the ventilation slots.
- Never open the charger. In case of defect, contact Gtech.
- This product contains Li-Ion batteries. Do not incinerate batteries or expose to high temperatures, as they may explode.
- Do not charge the battery when the surrounding air temperature or the battery pack is below 0°C or above 40°C.
- After heavy use or in high temperatures the battery may become warm. Allow the product to cool for 30 minutes before charging.
- Use only with the battery pack supplied.
- Leaks from battery cells can occur under extreme conditions. If the liquid gets on your skin wash immediately with soap and water. If the liquid gets into your eyes, flush them immediately with cold water for a minimum of 10 minutes and seek urgent medical attention.
- Protect the battery against excessive temperatures and fire.

- Do not store the battery outside for prolonged periods of time over the winter months.
- Do not dispose of the battery pack into household waste, fire or water. The battery pack should be collected, recycled or disposed of in an environmentally friendly manner. Discharge your battery pack by operating your Cordless Lawn Mower. Remove the battery pack from the housing and cover the battery pack connections with heavy duty ventilation tape to prevent a short circuit and energy discharge. Do not attempt to open or remove any of the components.
- Remove the battery and charger from the mains when fully charged.
- Unplug the charger from the mains and battery when fully charged.











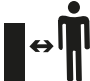

Service:

- Do not use the mower if the switch does not turn on or off. Any power tool that cannot be controlled by the switch is dangerous and must be removed or replaced.
- Before any servicing and cleaning take out the safety key and remove the battery.
- Check all visible fixing screws and nuts, especially on the cutter bar, to ensure they are tightened properly.
- Do not keep the mower in a damp room.
- Before using the the mower and after any impact, check for signs of wear and damage and repair or replace as necessary.
- Use only genuine replacement parts. This will ensure that the safety of the the mower is maintained.
- Do not attempt to repair any damaged parts on the mower unless you are qualified to do so.
- Please contact Gtech on 01905 345891 if you have any queries about your product.

Intended Use:

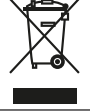
- This product is intended for DOMESTIC USE ONLY.

Warning Label Descriptions

	Warning/ Caution.		Remove safety key before servicing and cleaning.
	Beware of severing toes or hands. Do not put hands or feet near a rotating blade.		Dangerous voltage.
	Read the instruction manual.		Keep bystanders at a safe distance (at least 5m).
	Caution: Wait until blades stop rotating when switched off.		Always keep the lawnmower on the ground when mowing. Tilting or lifting the lawnmower may cause stones to be thrown out.
	Do not mow in the rain or leave the lawnmower outdoors while raining.		Do not dispose of Li-Ion battery with general household waste.
	Grass bin empty.		Grass bin full.
			Guaranteed Sound Power Level

- Please read this manual carefully. Familiarise yourself thoroughly with the controls and proper use of this machine. You should know how the machine works and how to immediately switch it off.
- Never let children use this mower. Never let adults work with this mower if not properly trained.
- Do not let any persons, especially small children, or pets near you while mowing.
- Take care not to slip or fall while mowing.



Thank you for choosing Gtech

“Welcome to the Gtech family. I started Gtech to create sensible, easy to use products that do a great job, and hope you get many years of trouble-free performance from your new product.”

Nick Grey – Inventor, owner of Gtech

Make a note of your product serial number code for future reference. You can find this in the grass box flap.

____-____-____~
____-____-____~
____-____-____~
____-____-____~

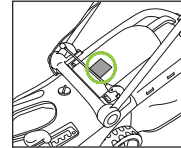

What's in the box

- 1 Chassis
- 2 Grass box
- 3 Charger
- 4 Battery

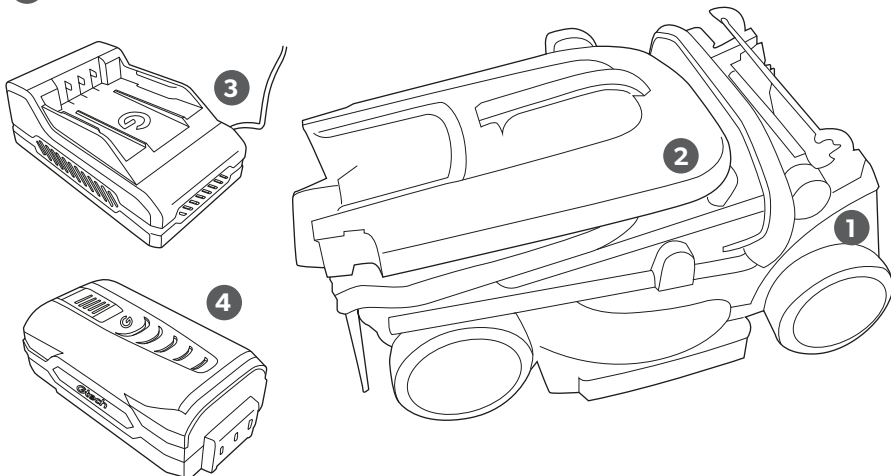

Handle set-up

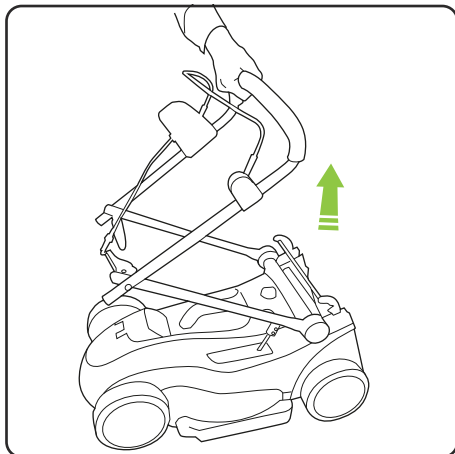

Put the grass box to one side and take hold of the mower's upper handle. Pull upwards to extend the handle assembly.

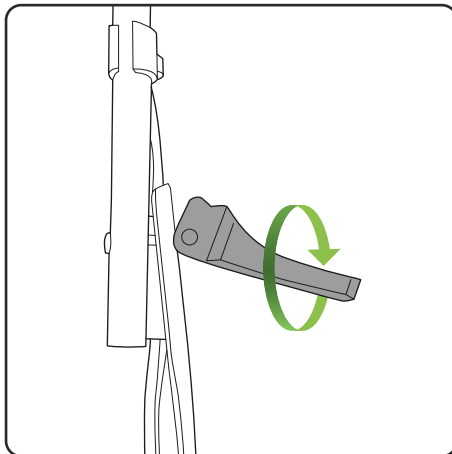

Twist the locking handles to tighten

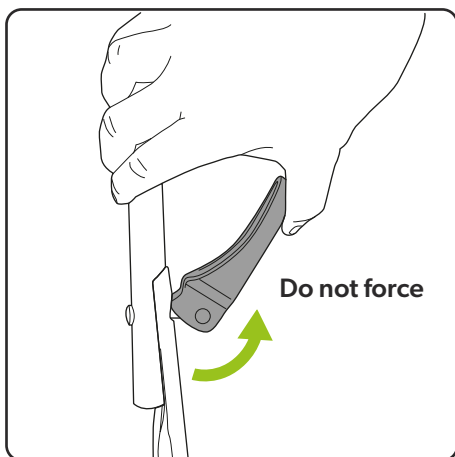

Push the locking handle 90 degrees towards the pole. If the locking handle struggles to lock then lower the locking handle, twist backwards to loosen and try again.

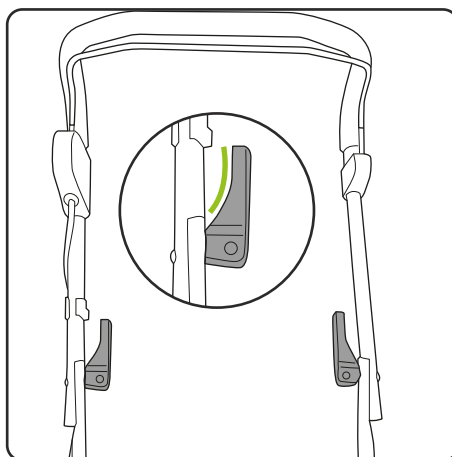

When correctly assembled the locking handles will be located on the inside of the handle frame with the curved section of the locking handle on the inside.

Grass box assembly

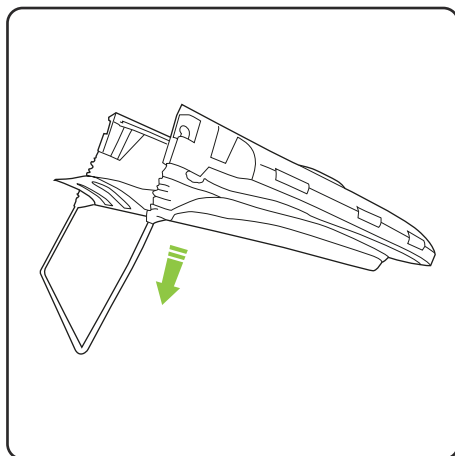

Push the base of the grass bin down.

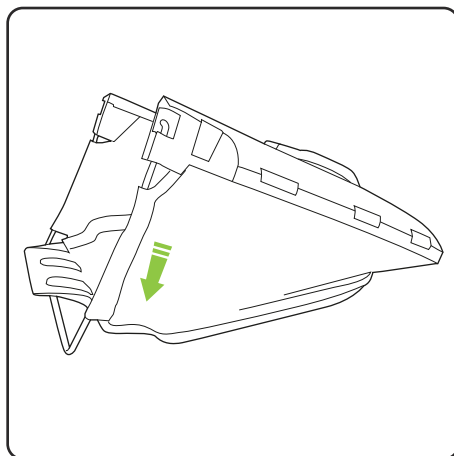

The scoop should be close to the metal rod at the bottom.

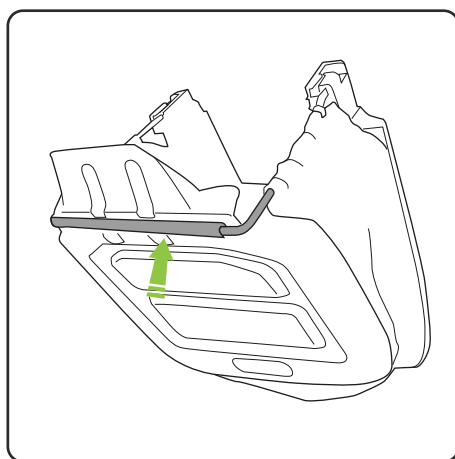

Then push the metal rod into the clip underneath the grass bin.

Fitting the grass box

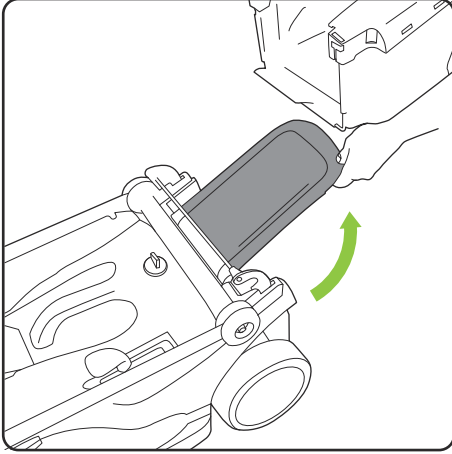

To fit the grass box onto the mower, lift up the protective flap.

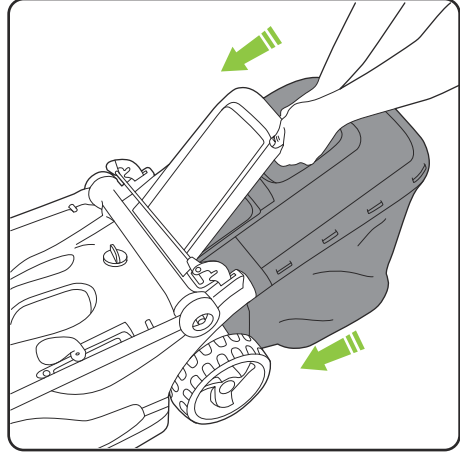

Insert the grass box into the back of the mower.

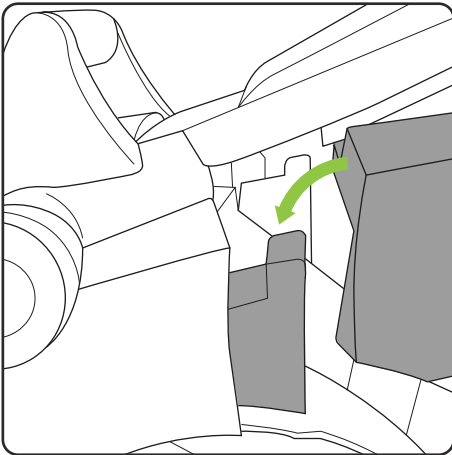

Ensure the hooks lock into place.

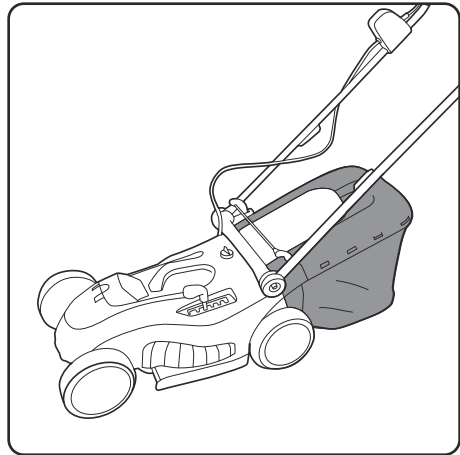

The grass box is now fully assembled.

Inserting the battery

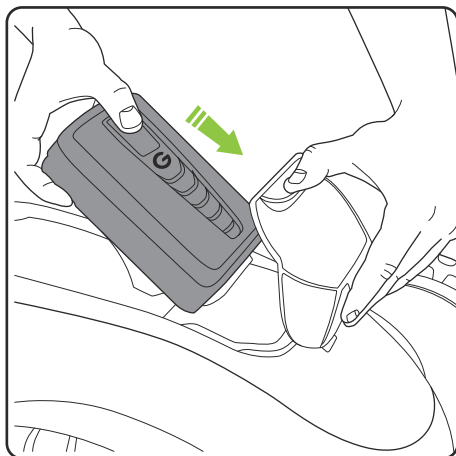

Ensure the 'G' logo is facing upwards when you slide the battery into the battery housing. It will push firmly into place once fitted correctly.

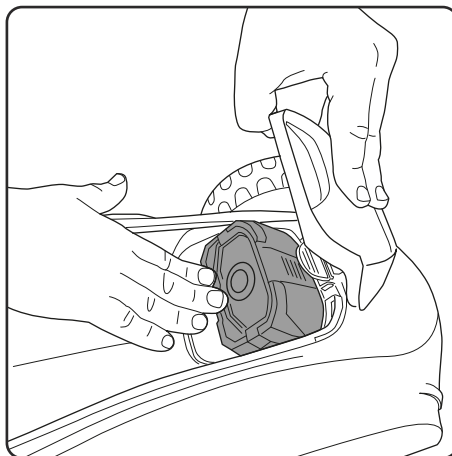

Ensure the battery is firmly pushed down and clicked into place in the battery housing.

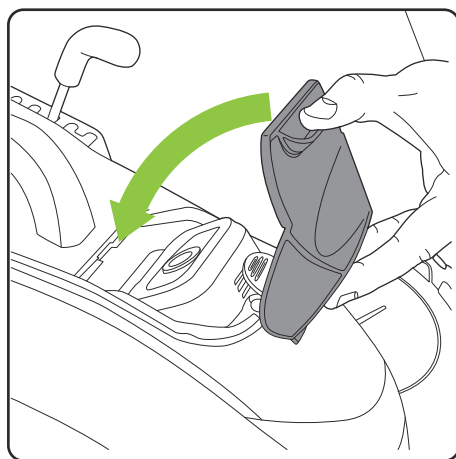

The visor will return to its original position.

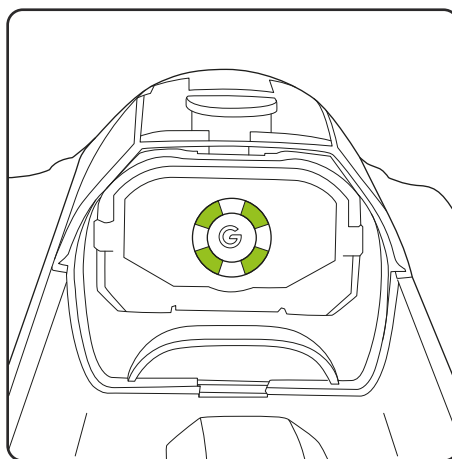

The state of charge indicator on the battery will be visible through the visor.

The safety key

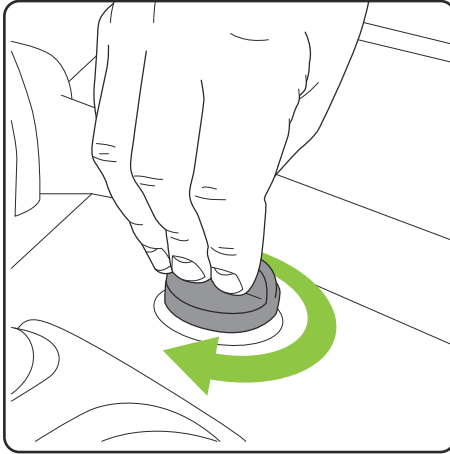

The mower will not work without the safety key. Rotate it 90° clockwise to operate.

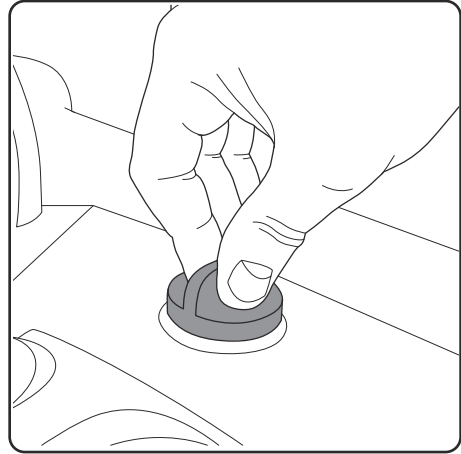

Once correctly in place, the mower will be ready to use.

Remove the key before you carry out any maintenance, clear any grass, carry the mower or put your hands near the blade.

Operating the Cordless Lawn Mower

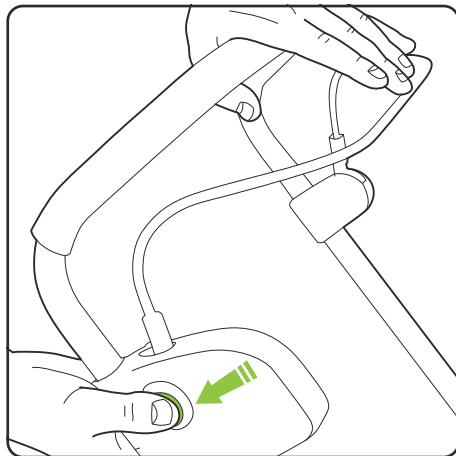

To operate the mower, press and hold the green safety button and then pull the lever under the handle.

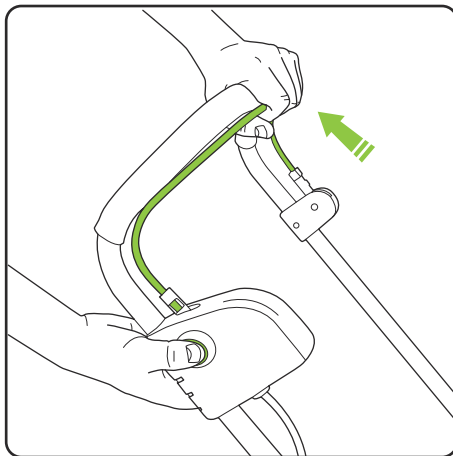

Pull the lever to the handle to start the mower. Releasing the lever will stop the mower.

Ensure the safety key has been activated before use.

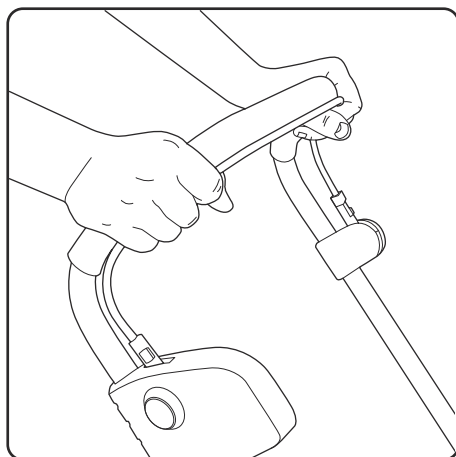

Once the mower is activated, you can release the safety button.

Adjusting the cutting height

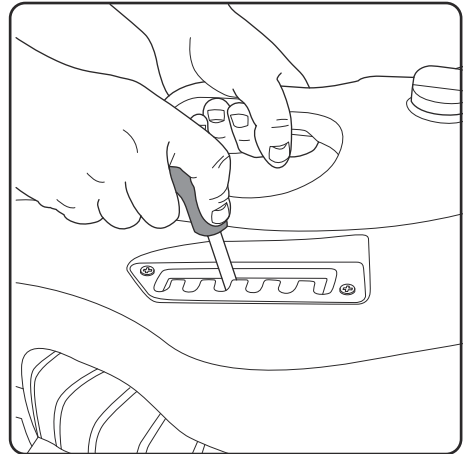
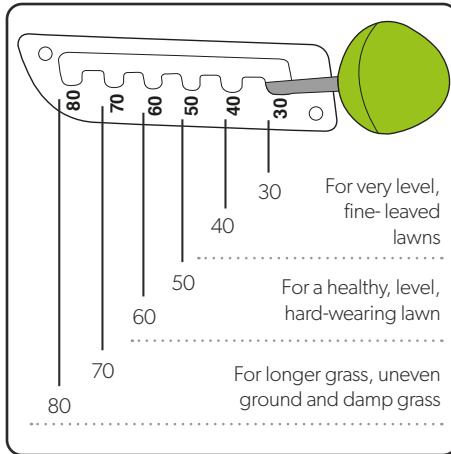

Note that the lower settings will scalp uneven lawns and reduce your lawn's resistance to wear and drought.

To adjust the height, hold the lever firmly and move it into the notch required.

When mowing on uneven ground, it is suggested you test the cutting height on a small patch of grass, to avoid cutting too deep and creating bald patches.

Using the Cordless Lawn Mower

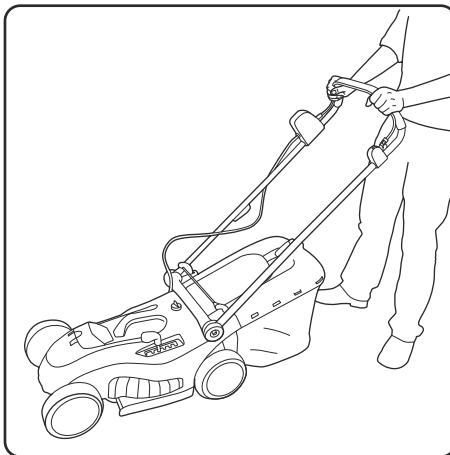

Push the mower along at a walking pace when mowing.

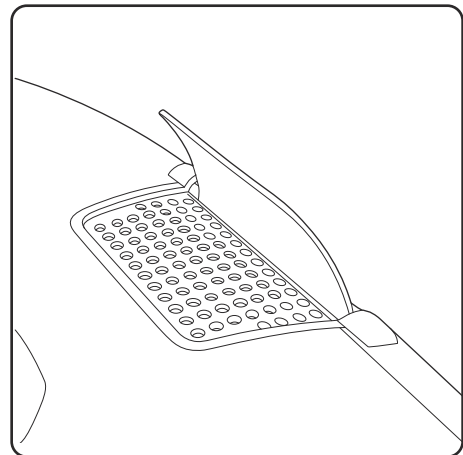

When the filling indicator flap closes, it is time to empty the bin. Note: if the bin over-fills, the grass chute will clog and the flap will close again.

WARNING: to reduce risk of personal injury, wait for the blade to stop rotating and remove the safety key before adjusting the cutting height.

Removing and emptying the grass box

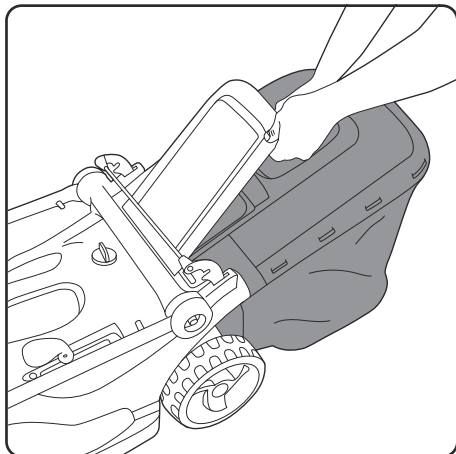

Lift the protective flap at the rear of the mower and grasp the green handle attached to the grass box.

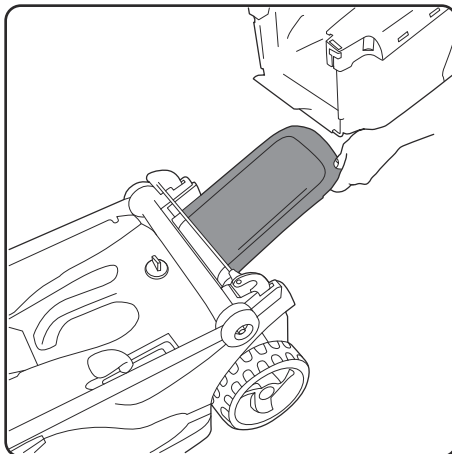

Whilst still lifting the protective flap, lift and pull the grass box towards you to remove from the mower.

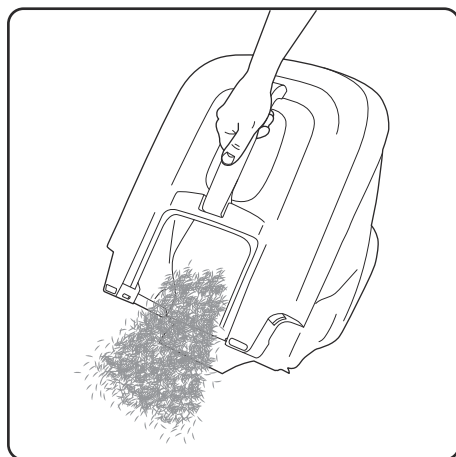

Empty your grass clippings in an appropriate location.

Charging the battery

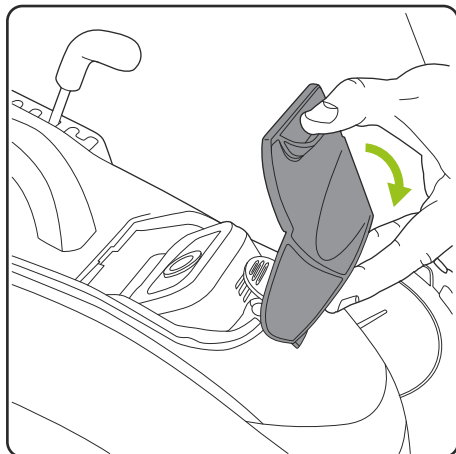

Reveal the battery by lifting the cover visor.

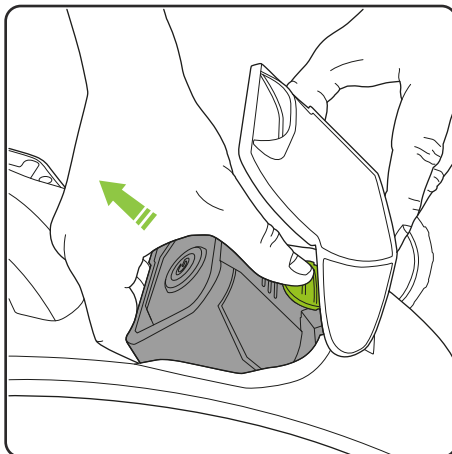

To unlock the battery, push the release latch located under the visor, then pull out the battery.

State of charge indicator

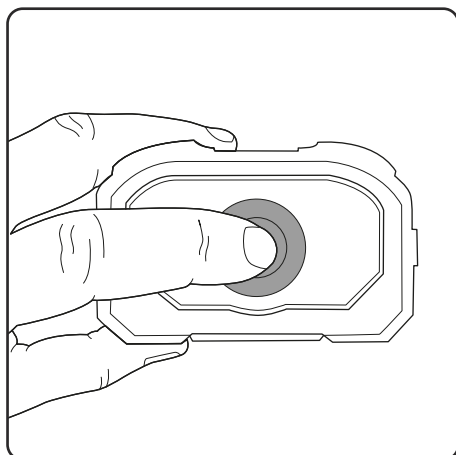

Press the button on the back of the battery to check how much charge there is.

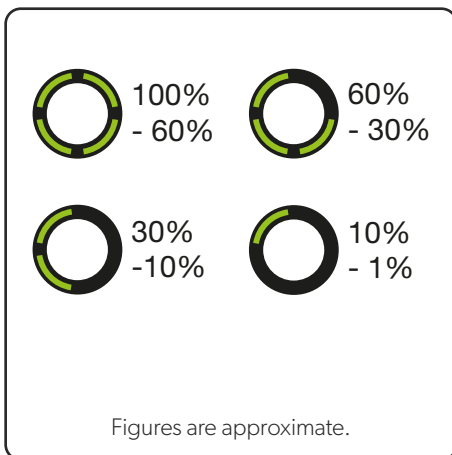

Figures are approximate.

The number of LEDs that are lit up show the state of charge.

Charging the battery

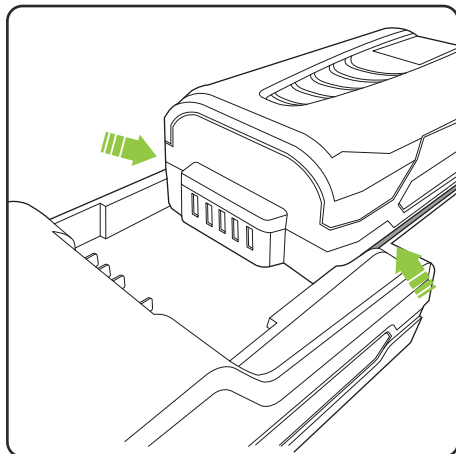

With the 'G' logo facing upwards on the battery, line up the runners on the sides of the battery with the runners on the battery charge stand and slide onto charger.

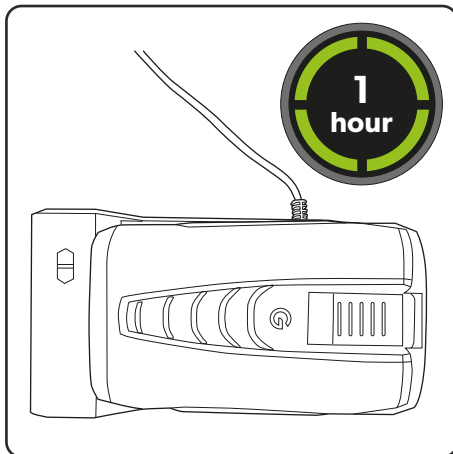

The charger will display a solid red light to indicate it is plugged in. Once the charging process has started, a green light will flash.

Charge time is approximately 1 hour. A solid green light will be displayed to indicate that the battery is fully charged.

Carrying the Cordless Lawn Mower

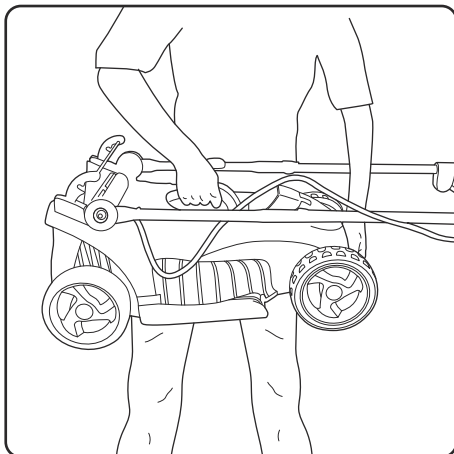

Before carrying the mower, make sure the safety key is removed to avoid starting it accidentally. The easiest way to carry the mower is by holding the middle carry-handle and the front of the mower.

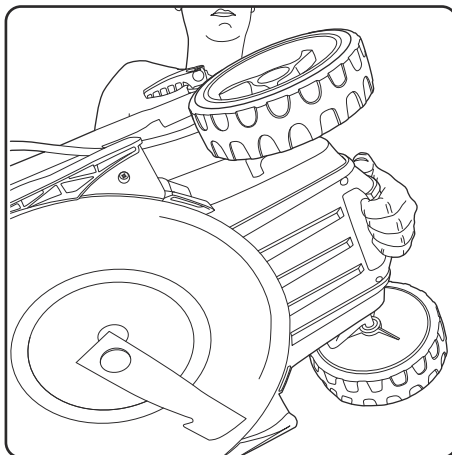

There is a hand-hold under the front of the mower.

Product Care



Wear protective gloves when handling, cleaning or replacing the blade.



To reduce the risk of injury ensure that safety key is removed when the mower is not in use, being transported, handled or stored.

To ensure that your Cordless Lawn Mower gives you long and reliable service, carry out the following maintenance regularly:

- Check for obvious defects such as a loose, dislodged, worn or damaged blade, loose fixings and worn, damaged, or loose parts.
- Check that any covers and guards are correctly fitted and undamaged.
- Always clean the cutting blade after use and apply a lubricating oil or spray before storage.
- Before use, check the condition of the cutting edges of the blade and ensure the blade fixings are secure.
- Do not use water, solvents or polishes to clean the mower. Wipe clean with a dry cloth.
- Do not use abrasive materials to clean the product, and do not immerse it in water.
- Store it in a secure, dry place, out of reach of children. Do not expose to moisture.

PLEASE NOTE: if the product needs to be repaired or replaced, only use replacement parts supplied by the manufacturer.

Spare parts can be purchased from Grey Technology Ltd.

Tel: **01905 345 891**

Web: **www.gtech.co.uk/support**

Troubleshooting

Motor not running	<ol style="list-style-type: none"> 1. Charge battery 2. Check safety key is inserted 3. Check switch operation
Irregular running/machine vibrating strongly	<ol style="list-style-type: none"> 1. Blade may be defective 2. Blade may be loose
Poor cutting/collection performance	<ol style="list-style-type: none"> 1. Empty/ unblock grass box 2. Charge/ check battery 3. Cutting height may need adjusting 4. Blade may be blunt
Mower leaves cut grass on lawn	<ol style="list-style-type: none"> 1. Check and clear the grass chute 2. Clean the bin fabric
Struggling to cut/jamming	<ol style="list-style-type: none"> 1. Push the mower more slowly 2. Increase cutting height 3. Check for a build-up of grass
Charger flashing red (slow)	Battery too hot - allow to cool
Charger flashing red (rapid)	Battery fault - call Gtech

Product support

If these initial tips do not solve your problem we please visit our support area where you can find troubleshooting help including online manuals, FAQs and how-to-videos, as well as genuine spares and replacement parts compatible with your product.

Visit: www.gtech.co.uk/support



Online



Live chat support



support@gtech.co.uk



How to Videos

GTECH CORDLESS LAWN MOWER TECHNICAL SPECIFICATION

Voltage	48V
Battery capacity	2.0 Ah Li-Ion
Blade speed	2800 rpm
Grass box capacity	50L
Charge time	1 hour
Cutting Width	420mm
Protection type	IPX 4
Measured sound power level	88.83 dB (A); K= 2.29 dB (A)
Guranteed sound power level	96 db(A)
Sound pressure level	77.9 dB (A); K= 3 dB (A)
Vibration	Left handle: 0.581 m/s ² Right handle: 1.274 m/s ² K= 1.5 m/s ²
Weight	13.5kg
Charger Input	220-240V~, 50/60Hz, 145W
Charger Output	58V DC----2A

Environmental and Product Recycling

The  symbol indicates that this product is covered by legislation for waste electrical and electronic products (EN2002/96/EC)

When the product has reached the end of its life please do not dispose of it with general household waste. Consider the environment and take it to a recognised recycling facility.

The product contains a Li-Ion battery which should not be disposed of with general household waste. The battery should be disposed of properly with the product at a recycling facility.

Call your local council, civic amenity site, or recycling centre for information on the disposal and recycling of electrical products.

Alternatively visit www.recycle-more.co.uk for advice on recycling and to find your nearest recycling facilities.



WARRANTY – REGISTRATION

Visit www.gtech.co.uk/warrantyregistration to register your product to ensure that we have all the information required to provide you with quick and efficient support.

You will need your product's serial code.

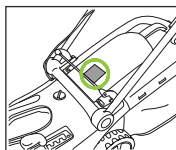

If you purchased directly from Gtech, your details are already registered and your 2-year warranty will start automatically.

If you purchased from an authorised Gtech retailer, please register your warranty within 3 months. You will need to provide proof of purchase to support any claim(s) against your warranty.

WARRANTY – TERMS AND CONDITIONS

If your product is within its warranty and has a fault that cannot be resolved from the troubleshooting section or online support, please do the following:

- Contact our Gtech Customer Care Helpline on UK: 08000 308 794, who will go through any troubleshooting with you to identify the fault.
- If your fault can be resolved by a replacement part, this will be sent to you free of charge.
- Following troubleshooting, if your product needs to be replaced, we will arrange collection of your faulty product for inspection, and delivery of a replacement product free of charge.

Your product is guaranteed against material or manufacturing faults for 2 years from the date of purchase (or the delivery date if this is later) subject to the following terms and conditions:

SUMMARY

The guarantee becomes effective at the date of purchase (or the date of delivery if this is later). If a product is repaired or replaced during the warranty period, the warranty period is not started again.

- You must provide proof of delivery/ purchase before any work can be carried out on the product. Without this proof, any work carried out will be chargeable. Please keep your receipt or delivery note.
- All work will be carried out by Gtech or its authorised agents.
- Any parts which are replaced will become the property of Gtech.
- The repair or replacement of your product is under guarantee and will not extend the period of guarantee.
- The guarantee provides benefits which are additional to and do not affect your statutory rights as a consumer.

WHAT ISN'T COVERED

Gtech does not guarantee the repair or replacement of a product as a result of:

- Normal wear and tear (e.g. drive belt, brush bar, batteries) .
- Use of consumables (e.g. dust bags and cartridges)
- Accidental damage, faults caused by negligent use or lack of care and maintenance, misuse, neglect, careless operation or handling of the product which is not in accordance with operating manual.
- Blockages. Please refer to the operating manual for details of how to unblock your product.
- Use of the product for anything other than the normal domestic household purposes.
- Use of parts and accessories which are not Gtech genuine components.
- Faulty installation (except where installed by Gtech)
- If it is modified in any way.
- Repairs or alterations carried out by parties other than Gtech or its authorised agents.
- Purchasing your product from an unofficial third party (i.e not from Gtech or an official Gtech retailer.
- If you are in doubt as to what is covered by your guarantee, please call the Gtech Customer Care Helpline on UK: 08000 308 794

International orders are subject to a delivery charge for both faulty and non faulty products.

EC Declaration of Conformity

We, the manufacturer/ importer,

Grey Technology Ltd
Brindley Road
Warndon
Worcester
WR4 9FB

declare that the following machine complies with the appropriate health and safety requirements of the following directives based on its design and type.

In case of alteration of the machine, not agreed upon by us, this declaration will lose its validity

Product's name / function: Cordless Lawn mower / for cutting grass.
Machine Type: CLM2.0
Rated voltage: 48VDC
Measured sound power level: 88,83 dB(A) K= 2.29 dB (A)
Guaranteed sound power level: 96dB(A)

Notified Body: Conformity assessment method to Directive 2000/14/EC and 2005/88/EC
The EC type-examination certificate is issued by SGS
Notified body of Noise directive:
AV Technology
Unit 2 Easter Court Europa Boulevard Warrington, Cheshire,
WA5 7ZB, United Kingdom.
Notified Body number:1067

Applicable EC Directives: EMC Directive 2014/30/EU
Machinery Directive 2006/42/EC
Noise Directive 2000/14/EC and 2005/88/EC
RoHS Directive 2011/65/EU

Applicable Harmonized Standards: EN 60335-1
EN 60335-2-77
EN 55014-1
EN 55014-2
EN 62321

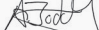
Authorized Signature/Date/ Place:  12/12/2019

Title of Signatory: Technical Manager

Name and address of the person authorised to compile the technical file, who must be established in the community:

Andrew Boddy
Grey Technology Ltd
Brindley Road
Warndon
Worcester
WR4 9FB



Gtech

Grey Technology Limited

Brindley Road, Warndon, Worcester WR4 9FB

email: support@gtech.co.uk

telephone: 08000 308 794

www.gtech.co.uk

CPN4692